

Uni Brother OEM Chip Reset
Operation Instruction
V1.0

Contents

1. Feature2

2. Operating Procedure.....2

3. Notice3

4. Code Alerts and Meanings4

5. Pictures of the Chip for Brother and the JIG4

OEM Chip Reset Operation Instruction



1. Feature

Automatically identify models, reset to the exact model without changing the color, yield, and region.

2. Operating Procedure

OEM Reset& OEM Check.

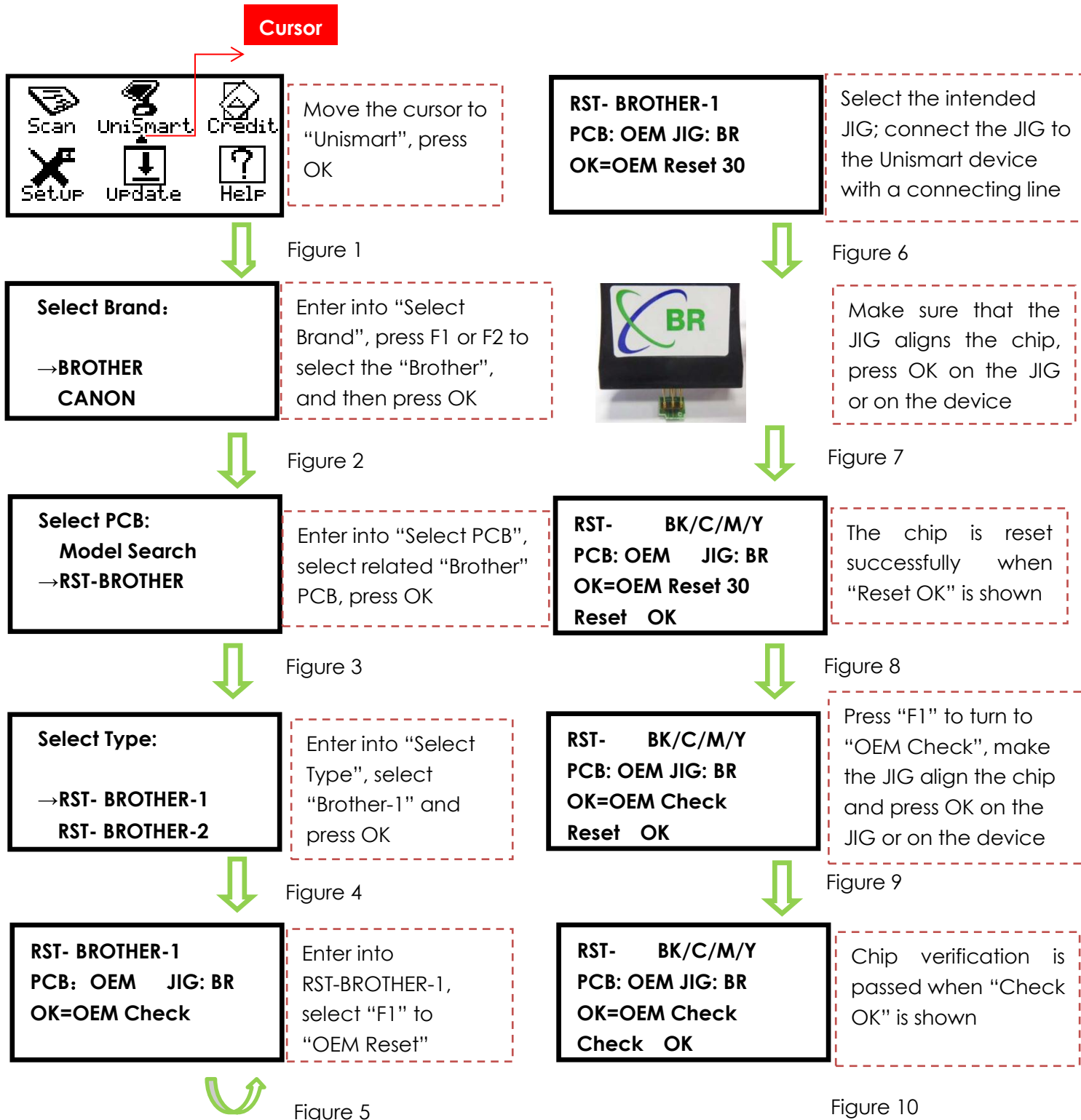

Note: the operation procedure above is for BROTHER-1 series and it can also be applied to other PCB boards.

3. Notice

- ◆ For Brother's chips, the chip models will not display on the Unismart device, and the OEM chip will only be reset to its original model.
- ◆ After resetting the OEM chip, if the ink in the cartridge is low or run out and WE STILL install the chip at this time, the printer will confirm the actual chip life by the ink detecting device on the cartridge and give "X" or "!" alerts. Meanwhile, the printer will rewrite the chip's data to related status.
- ◆ The chip of starter cartridges can only be used in specific printer. For example, after resetting the "LC201" chip and "LC203" chip of the starter cartridges, "LC201" chip can only be used in printer A (applied to starter cartridge 201), and "LC203" chip can only be used in printer B (applied to starter cartridge 203).
- ◆ However, both standard yield "LC201" chip and high yield "LC203" chip can be used in the standard cartridge.



Printer A

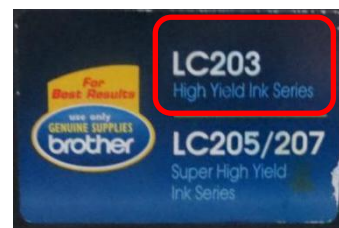

Printer B

- ◆ Differences between the starter cartridge and the standard cartridge. Please see the pictures below:



Starter Cartridge



Standard Cartridge

4. Code Alerts and Meanings

Code Alerts	Meanings	Reasons
Comm.fail Reset fail	Chip communication failed	1. The chip is damaged. 2. The JIG does not align the contactors on the chip. 3. The JIG is placed in the opposite direction.
Chip not match	Chip does not match	The current model cannot be used on the current chip.
Data not match	Data does not match	The chip is recognized, the detected data does not match the selected model.

5. Pictures of the Chip for Brother and the JIG



Chip

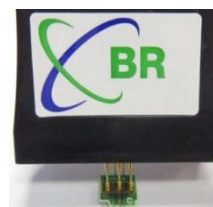

JIG

"Apex" herein refers to Apex Microelectronics Co., Ltd. The information contained herein is subject to change without prior notification. Apex shall not be liable for technical or editorial errors or omissions contained herein. Photographed products may not always match the description.